



**Pagoda
Landscape
Renovation
Project**

PROJECT BACKGROUND

- 2018** The Friends of the Japanese Tea Garden, in partnership with the Department, launched the Japanese Tea Garden Revitalization Campaign.
- SPRING 2020** Pagoda Structure restoration began in Spring 2020 and will be complete in the Fall of 2022. The Temple Gate was painted.
- SUMMER 2020** Kurisu LLC was selected as designer for the landscape renovation.
- SUMMER 2022** Final Concept Design and CEQA Exemption Issued.



PAGODA RESTORATION

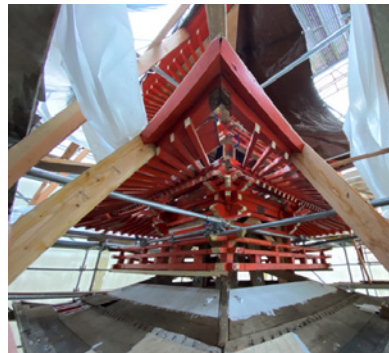

PROJECT LOCATION

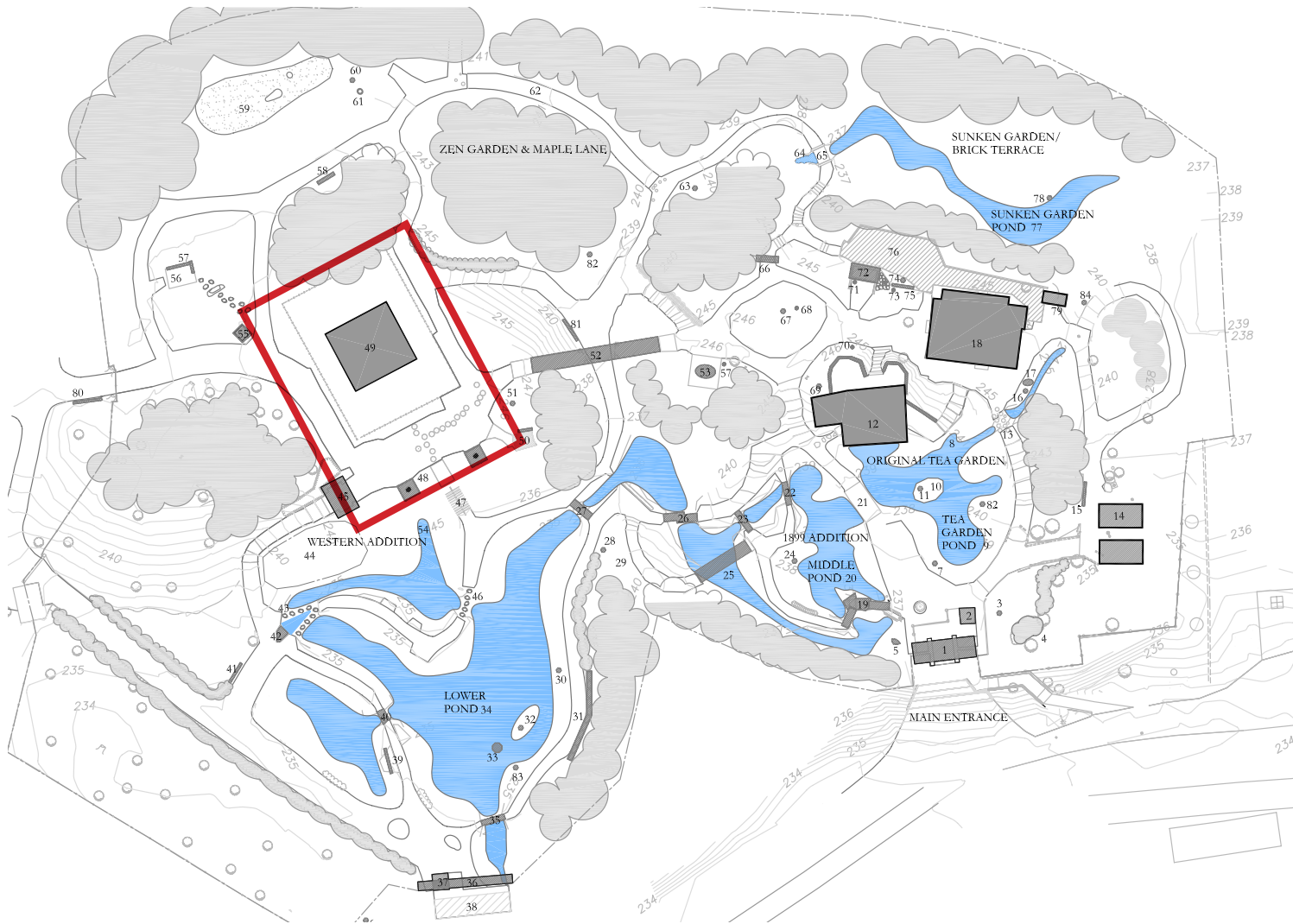

PAGODA LANDSCAPE IMPROVEMENT PROJECT I GOLDEN GATE PARK JAPANESE TEA GARDEN

PERSPECTIVE VIEW



PAGODA LANDSCAPE IMPROVEMENT PROJECT | GOLDEN GATE PARK JAPANESE TEA GARDEN

COMMUNITY OUTREACH



Community Meeting #1, 10/29/2021



Community Meeting #2, 6/27/2022

PROJECT SUPPORT

- Japantown Task Force
- Japan Society of Northern California
- Japanese Chamber of Commerce of Northern California
- Japanese Tea Garden Honoree Committee
- Friends of the Japanese Tea Garden
- San Francisco Parks Alliance
- Carol Murata, Owner of the Japanese Tea Garden Gift Shop and Tea House
- Japanese Cultural Center of Northern California (the Center)
- National Japanese American Historical Society (NJAHS)
- Hokka Nichi Bei Kai, also known as The Japanese American Association of Northern California
- Japanese American National Library
- Japanese American Religious Federation
- SF Botanical Garden
- Japanese Consul General Office
- RPD Department Staff

HOICHI KURISU

President and Founder of Kurisu LLC, Hoichi Kurisu studied landscape design and construction under distinguished designer Kenzo Ogata in Tokyo, Japan.

From 1968 to 1972, Hoichi served as Landscape Director for the Japanese Garden Society, and supervised construction of the Portland Japanese Gardens.

In 1972, Hoichi founded Kurisu International, Inc., a landscape design/build firm whose unique gardens create “inner space” for inspiration and healing.

Kurisu believes in the restorative powers of nature and the necessity of natural encounters for lasting health of our minds, bodies, and communities. In pursuit of this mission, Kurisu has established a reputation for gardens of the highest quality and has completed projects across the United States, in Japan, and internationally.





Japanese Lantern, Washington D.C.

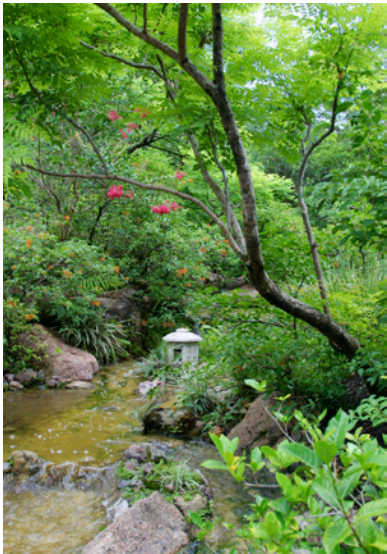

Morikami Museum, Florida

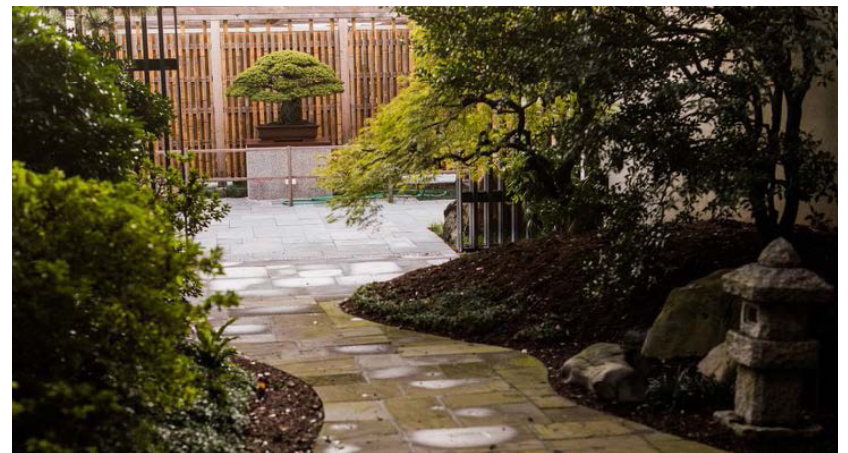

National Arboretum, Washington D.C.

*Western gardens are built from the master plan down.
Japanese gardens are built from the ground up.*

Marc Peter Keane, author, educator, artist, and
designer of Japanese gardens



Hoichi Kurisu is quite talented at making designs and drawing them up on paper. However, his true skill lies in working with physical materials in the landscape. The reason that Japanese gardens are built from the ground up is that each object in the garden needs to speak to its surroundings. A stone is placed, and the next stone needs to speak to it. The trees, structures, even the ground plane are all connected to one another. The only way to remain true to the tradition of the Japanese garden is to have the builder also be the designer. In our current time and place, there may not be anyone who understands this better than Hoichi Kurisu.

This is how it is done in Japan, and this is how it is done in the finest Japanese gardens outside of Japan.

Steven Pitsenbarger, Supervisor, Japanese Tea Garden